

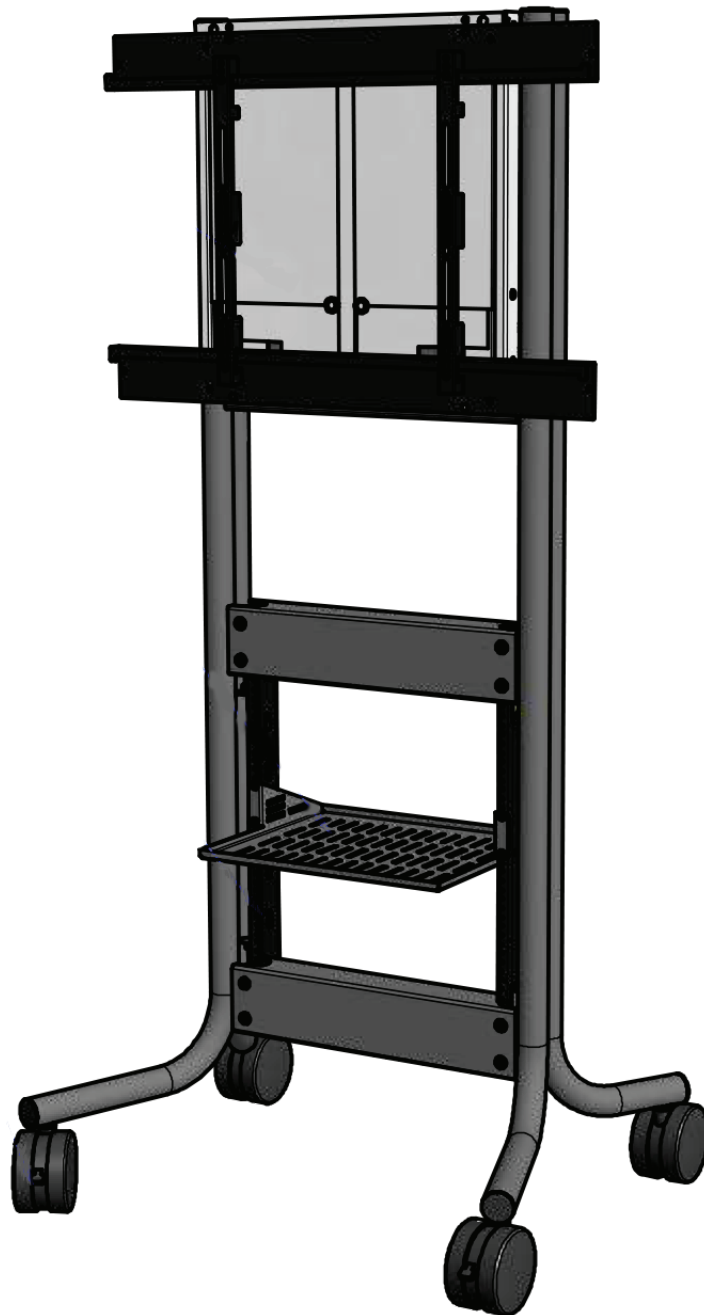

EASY SETUP GUIDE

DynamiQ RPS-500



Items included

Items not included:
- Phillips screw driver

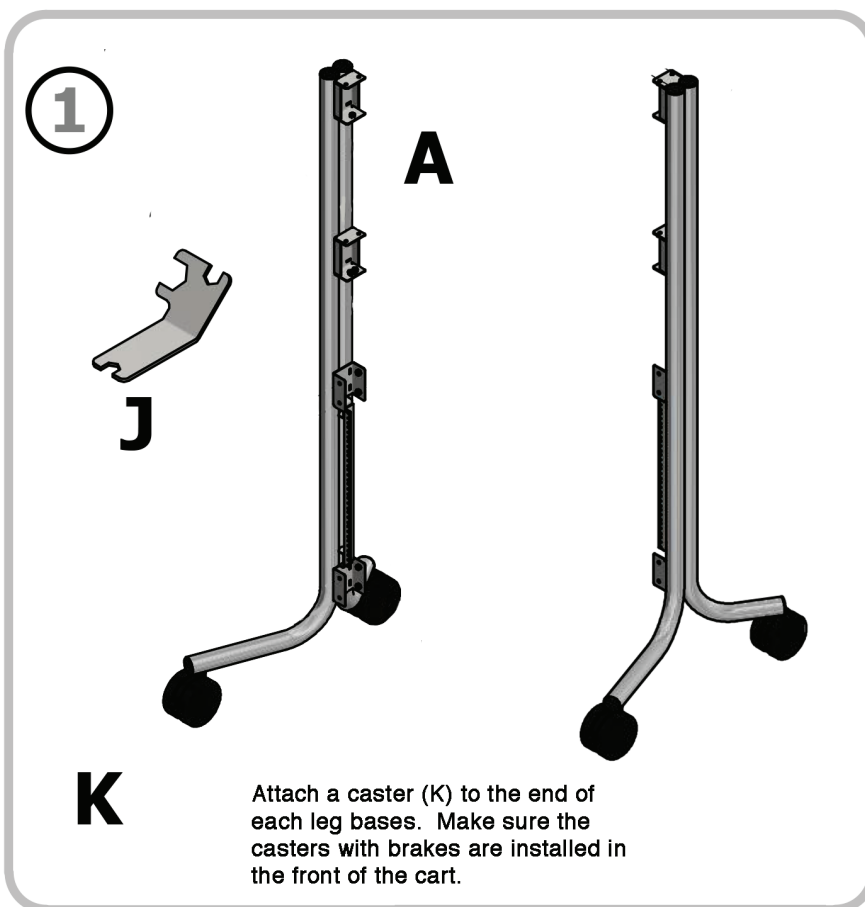
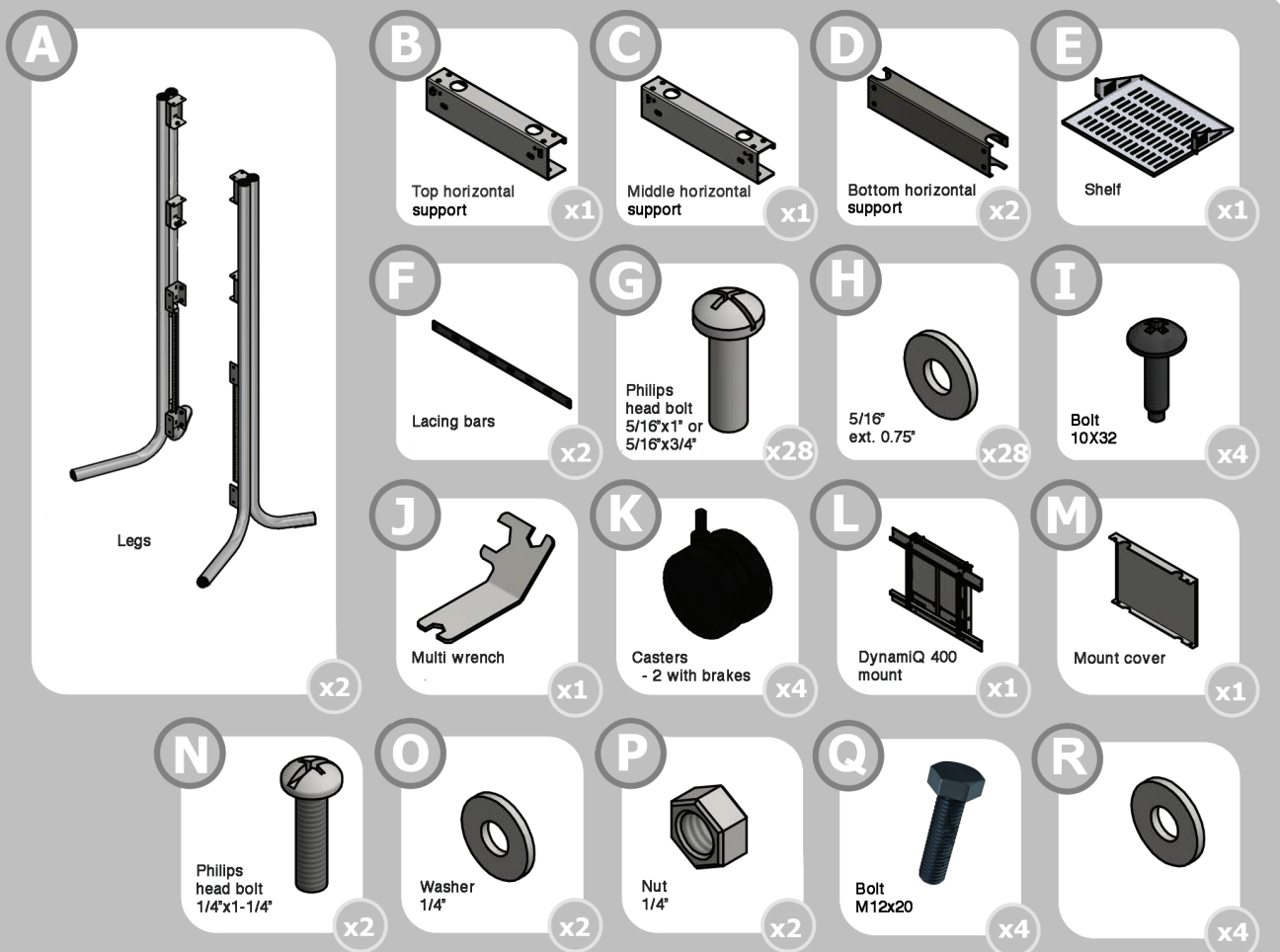

2

Attach each of the horizontal supports (B) (C) (D) to the first leg (A) using the screws (G) and nuts (H) as shown. Make sure the flat side of each support is facing the front of the cart.

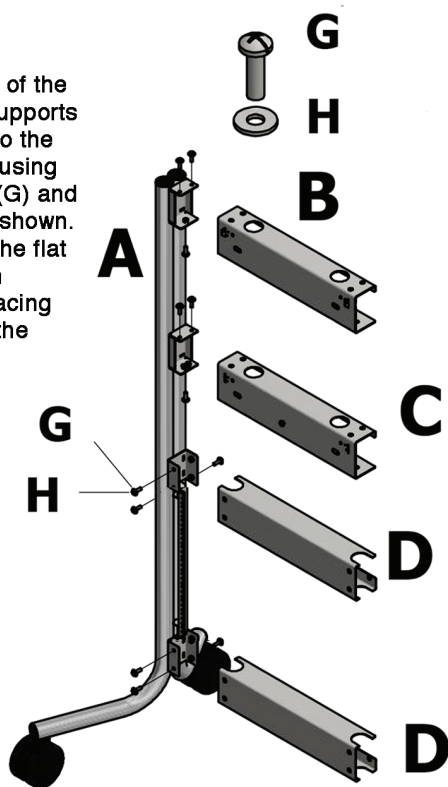

3

Attach the other leg to the horizontal supports.

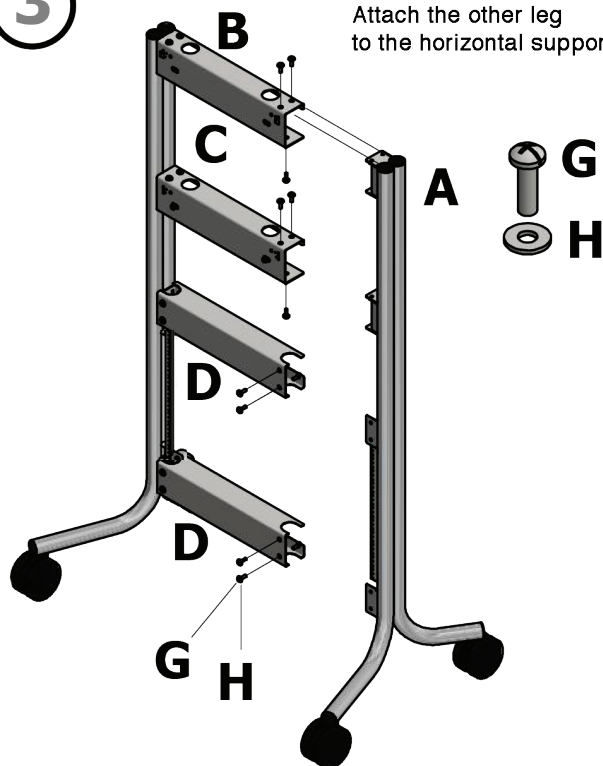

4

M

E

I

Secure cover (M) between the top and middle horizontal supports using the head bolts (G) and washers (H), as shown.

Install the shelf (E) to the vertical rack rails using the bolts (I).

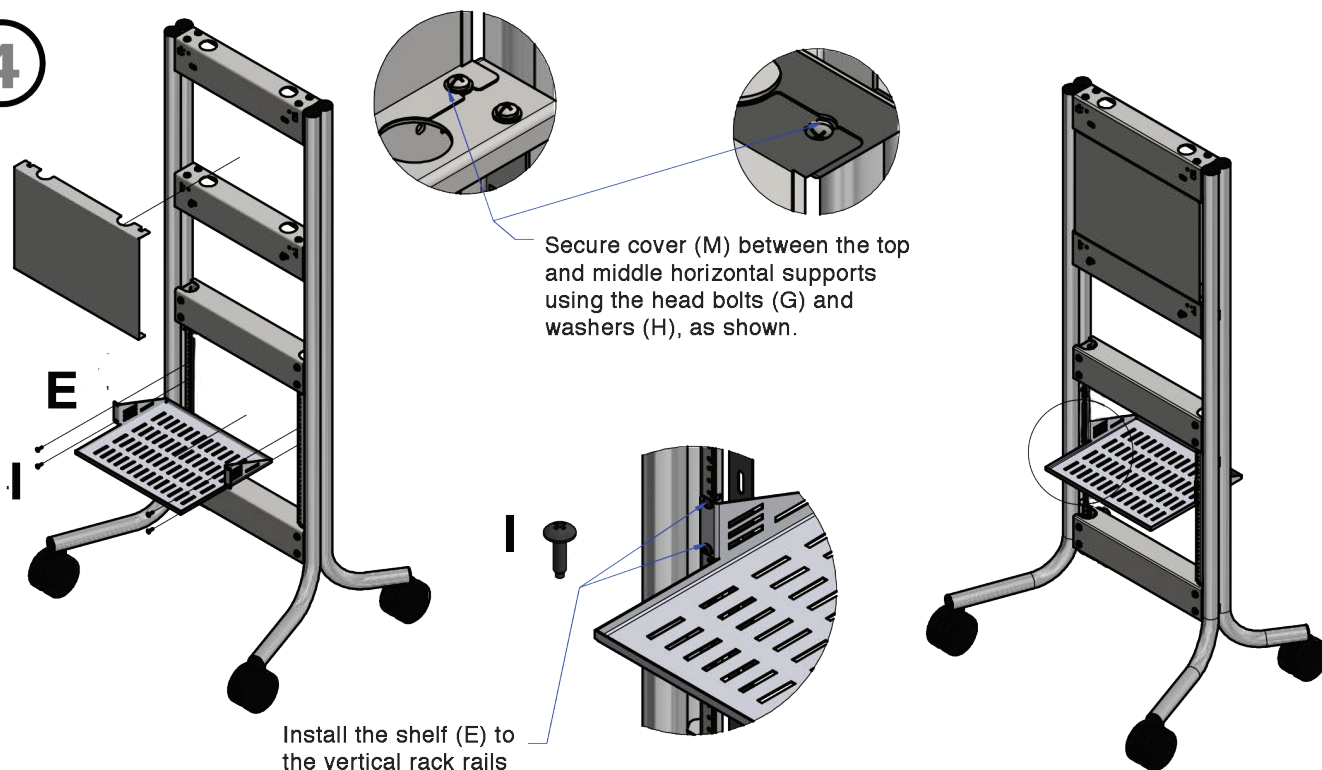

5

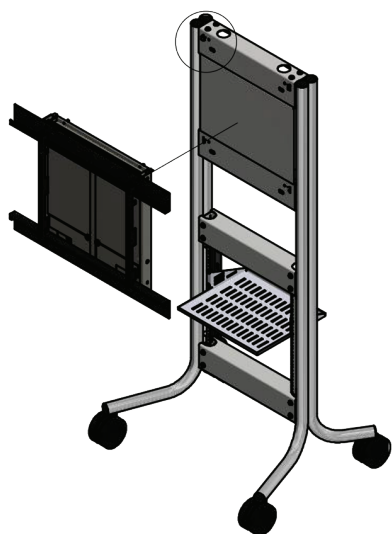

Hole in DynamiQ 400 mount

Hook on top horizontal support

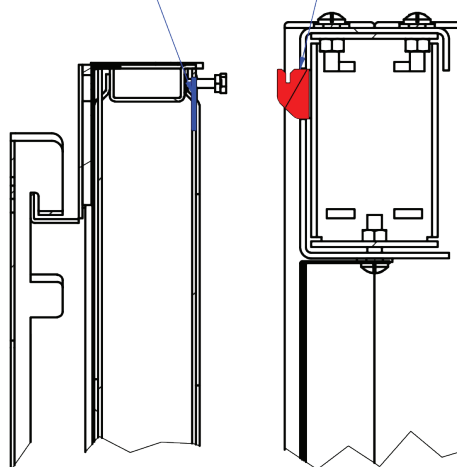

Attach the DynamiQ 400 mount (L) to the frame by aligning the holes on each side of the mount with the hooks on the top horizontal support.

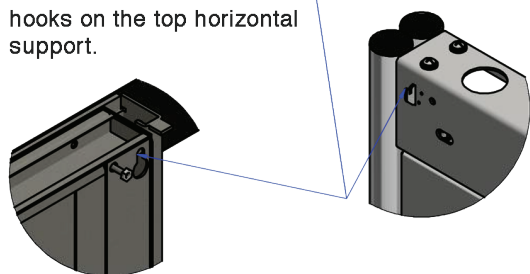

Hang mount to frame

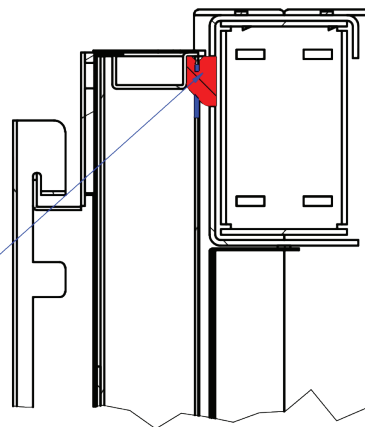

6

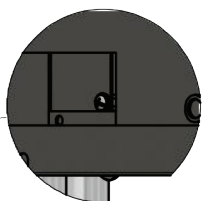
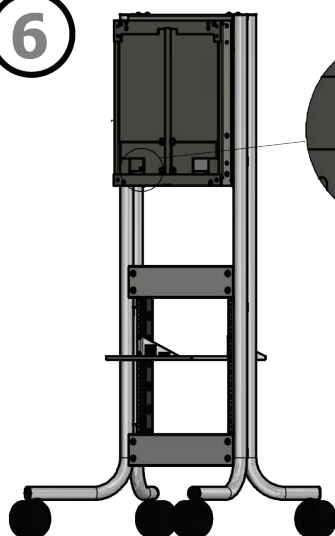

Secure with screw

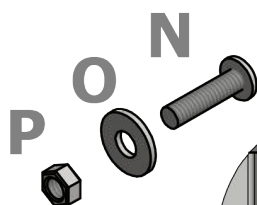
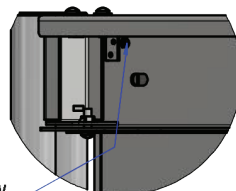

Secure with screw (N), washer (O) and nut (P).

